

APPLICATION FOR BUILDING PERMIT AND PLAN EXAMINATION

CHECK FOR ANY DEED RESTRICTIONS

BLACKMAN CHARTER

APPLICABLE TO THIS PROPERTY

TOWNSHIP

Use Group

AND/OR CONSTRUCTION.

1990 W. Parnall Rd.

Category

Jackson, Michigan 49201

Cons Type

(517) 788-4345

AUTHORITY: P.A. 230 of 1972, AS AMENDED

COMPLETION: MANDATORY TO OBTAIN PERMIT

PENALTY: PERMIT WILL NOT BE ISSUED

THE DEPARTMENT OF CONSUMER AND INDUSTRY SERVICES WILL NOT DISCRIMINATE AGAINST ANY INDIVIDUAL OR GROUP BECAUSE OF RACE, SEX, RELIGION, AGE, NATIONAL ORIGIN, COLOR, MARITAL STATUS, HANDICAP, OR POLITICAL BELIEFS.

APPLICANT TO COMPLETE ALL SHADED ITEMS

PARCEL NUMBER 000-08-

I. PROJECT INFORMATION

PROPERTY OWNER

ADDRESS

CITY

TOWNSHIP

BLACKMAN

COUNTY **JACKSON**

ZIP CODE 4920

II IDENTIFICATION

A. OWNER OR LESSEE

NAME

ADDRESS

CITY

STATE

ZIP CODE

TELEPHONE

B. ARCHITECT / ENGINEER OR OWNER OF PROPERTY

NAME

ADDRESS

CITY

LICENSE NUMBER

STATE

ZIP CODE

TELEPHONE

C. CONTRACTOR

NAME

ADDRESS

CITY

STATE

ZIP CODE

TELEPHONE

BUILDERS LICENSE NUMBER

EXPERATION DATE

EMAIL ADDRESS

III. TYPE OF IMPROVEMENT AND PLAN REVIEW

A. TYPE OF IMPROVEMENT

☐ NEW BUILDING

☐ ADDITION

☐ ALTERATION

☐ REPAIR

☐ WRECKING

☐ MOBILE HOME SET-UP

☐ FOUNDATION ONLY

☐ PREMANU FACT

☐ RELOCATION

B. REVIEW(S) TO BE PERFORMED

☐ BUILDING

☐ PLUMBING

☐ MECHANICAL

☐ ELECTRICAL

☐ ENERGY

☐ REPLACE ROOF

☐ REPLACE WINDOWS

IV. PROPOSED USE OF BUILDING

A. RESIDENTIAL - For "Demolition", show most recent use

<input type="checkbox"/> ONE FAMILY	<input type="checkbox"/> TWO OR MORE FAMILY	<input type="checkbox"/>	HOTEL, HOTEL	
	NO. OF UNITS _____		NO. OF UNITS _____	
<input type="checkbox"/> ATTACHED GARAGE	<input type="checkbox"/> DETACHED GARAGE	<input type="checkbox"/>	OTHER	

B. NON-RESIDENTIAL

<input type="checkbox"/> AMUSEMENT	<input type="checkbox"/> CHURCH, RELIGION	<input type="checkbox"/> INDUSTRIAL
<input type="checkbox"/> PARKING GARAGE	<input type="checkbox"/> SERVICE STATION	<input type="checkbox"/> HOSPITAL, INSTITUTIONAL
<input type="checkbox"/> OFFICE, BANK, PROFES	<input type="checkbox"/> PUBLIC UTILITY	<input type="checkbox"/> SCHOOL, LIBRARY, EDUCATIONAL
<input type="checkbox"/> STORE, MERCANTILE	<input type="checkbox"/> TANKS, TOWERS	<input type="checkbox"/> OTHER

GIVE DESCRIPTION OF WORK BEING DONE RESIDENTIAL OR NONRESIDENTIAL

[illegible][illegible]

ESTIMATED CONSTRUCTION COST: FOR COMMERICAL ADD., ALT.,REMODEL & SIGNS ONLY

[illegible]

V. SELECTED CHARACTERISTICS OF BUILDING				
-----------------------------------------	--	--	--	--

A. PRINCIPAL TYPE OF FRAME	
1	1.1
2	2.1
3	3.1
4	4.1
5	5.1
6	6.1
7	7.1
8	8.1
9	9.1
10	10.1
11	11.1
12	12.1
13	13.1
14	14.1
15	15.1
16	16.1
17	17.1
18	18.1
19	19.1
20	20.1
21	21.1
22	22.1
23	23.1
24	24.1
25	25.1
26	26.1
27	27.1
28	28.1
29	29.1
30	30.1
31	31.1
32	32.1
33	33.1
34	34.1
35	35.1
36	36.1
37	37.1
38	38.1
39	39.1
40	40.1
41	41.1
42	42.1
43	43.1
44	44.1
45	45.1
46	46.1
47	47.1
48	48.1
49	49.1
50	50.1
51	51.1
52	52.1
53	53.1
54	54.1
55	55.1
56	56.1
57	57.1
58	58.1
59	59.1
60	60.1
61	61.1
62	62.1
63	63.1
64	64.1
65	65.1
66	66.1
67	67.1
68	68.1
69	69.1
70	70.1
71	71.1
72	72.1
73	73.1
74	74.1
75	75.1
76	76.1
77	77.1
78	78.1
79	79.1
80	80.1
81	81.1
82	82.1
83	83.1
84	84.1
85	85.1
86	86.1
87	87.1
88	88.1
89	89.1
90	90.1
91	91.1
92	92.1
93	93.1
94	94.1
95	95.1
96	96.1
97	97.1
98	98.1
99	99.1
100	100.1

☐ MASONRY, W ☐ WOOD FRAME ☐ STRUCTURAL STEEL ☐ REINFORCED CONCRETE ☐ OTHER

B. PRINCIPAL TYPE OF HEATING FUEL	
1	1

<input type="checkbox"/> GAS	<input type="checkbox"/> OIL	<input type="checkbox"/> ELECTRICITY	<input type="checkbox"/> COAL	<input type="checkbox"/> OTHER
------------------------------	------------------------------	--------------------------------------	-------------------------------	--------------------------------

[illegible]

<input type="checkbox"/> PUBLIC OR PRIVATE COMPANY	<input type="checkbox"/> SEPTIC SYSTEM
----------------------------------------------------	----------------------------------------

D. TYPE OF WATER SUPPLY	
1. <u>Public</u>	2. <u>Private</u>
3. <u>Other</u>	

<input type="checkbox"/> PUBLIC OR PRIVATE COMPANY	<input type="checkbox"/> PRIVATE WELL OR CISTERN
----------------------------------------------------	--------------------------------------------------

E. TYPE OF MECHANICAL	
-----------------------	--

WILL THERE BE AIR CONDITIONING?	<input checked="" type="checkbox"/> YES	<input type="checkbox"/> NO						
---------------------------------	-----------------------------------------	-----------------------------	--	--	--	--	--	--

F. DIMENSIONS/DATA							
---------------------------	--	--	--	--	--	--	--

NUMBER OF STORIES _____				FLOOR AREA:		TOTAL LAND AREA _____			
								(SQUARE FEET)	
				1ST & 2ND FLOOR _____					
				3RD - 10TH FLOOR _____					
				TOTAL AREA _____					

G. NUMBER OF OFF STREET PARKING SPACES

ENCLOSED _____						OUTDOORS _____						

VI. APPLICANT INFORMATION

WARNING NOTICE

NO OCCUPANCY PERMITS WILL BE ISSUED OR PERSONS ALLOWED TO MOVE ON THE PREMISES UNTIL FINAL APPROVAL HAS BEEN RECEIVED FOR ALL BUILDING, MECHANICAL, PLUMBING, AND/OR ELECTRICAL WORK PERFORMED ON THE PREMISIS, IN ADDITION TO ZONING AND DEPT. OF PUBLIC WORKS APPROVAL.

APPLICANT IS RESPONSIBLE FOR THE PAYMENT OF ALL FEES AND CHARGES APPLICABLE TO THIS APPLICATION AND MUST PROVIDE THE FOLLOWING INFORMATION.

I HEREBY CERTIFY THAT THE PROPOSED WORK IS AUTHORIZED BY THE OWNER OF RECORD AND THAT I HAVE BEEN AUTHORIZED BY THE OWNER TO MAKE THIS APPLICATION AS HIS/HER AUTHORIZED AGENT, AND WE AGREE TO CONFORM TO ALL APPLICABLE LAWS OF THE STATE OF MICHIGAN. ALL INFORMATION SUBMITTED ON THIS APPLICATION IS IS ACCURATE TO THE BEST OF MY KNOWLEDGE.

Section 23a of the state construction code act of 1972, 1972 PA 230, MCL 125.1523A, to circumvent the licensing requirements of this state relating to persons who are to perform work on a residential building or a residential structure. Violators of section 23a are subjected to civil fines.

FEE ENCLOSED \$ OR STATE ACCOUNT NO.

Signature of Applicant

Application Date

VII. LOCAL GOVERNMENTAL AGENCY TO COMPLETE THIS SECTION**ENVIRONMENTAL CONTROL APPROVALS**

	REQUIRED?	APPROVED	DATE	NUMBER	BY
A- ZONING/DISTRICT	YES NO				
1. SITE PLAN APPROVAL	YES NO				
2. VARIANCE GRANTED	YES NO				
B-FIRE	YES NO				
C-POLLUTION CONTROL	YES NO				
D- FLOOD ZONE	YES NO				
E- SOIL EROSION/COUNTY D	YES NO				
F- TWP. WATER/SEWER	YES NO				
G- WATER/COUNTY HEALTH	YES NO				
H- SEPTIC/COUNTY HEALTH	YES NO				
I- COUNTY ROAD COMM.	YES NO				
J- ASSESSING DEPT.	YES NO				

COMPUTER PROPERTY TAX # _____

ALL PERSONAL AND PROPERTY YES _____ NO _____

VIII. VALIDATION

BUILDING PERMIT NUMBER		APPROVED BY			
ISSUE DATE		SIGNATURE			

ILLUSTRATIONS OF ZONING TERMS GENERAL LOT TERMS

FILL IN ALL MEASUREMENTS BETWEEN PROPERTY LINES AND BUILDINGS

WRITE THE NUMBERS IN THE OPENINGS IN THE LINES

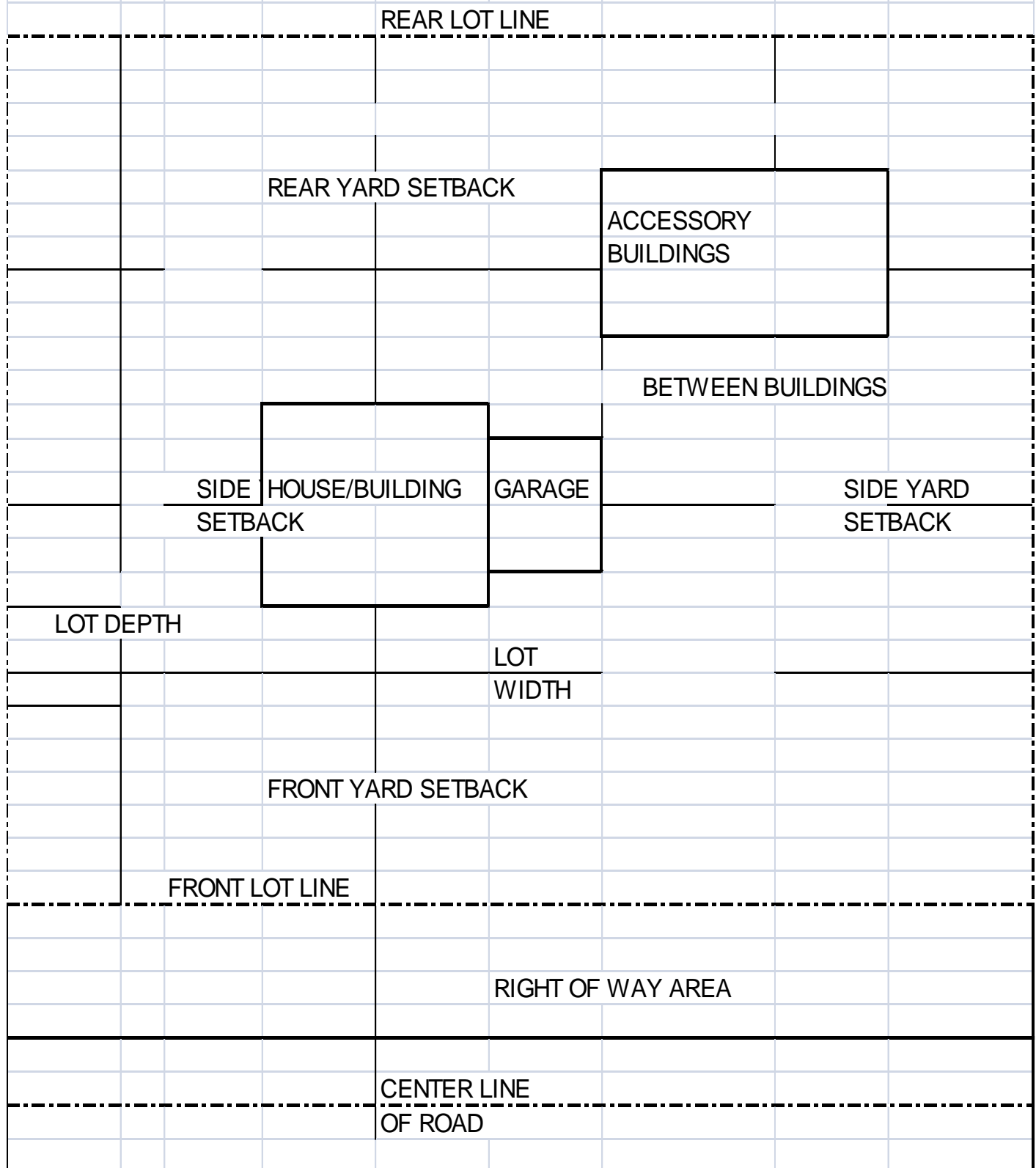

BLACKMAN CHARTER TOWNSHIP BUILDING PERMIT FEES
IN COMPUTING THE CONSTRUCTION COST AND BUILDING
PERMIT FEES, THE COMPUTATION SHALL BE AS FOLLOWS:

ADMINISTRATION FEE	\$25.00 ALL PERMITS SUBJECT TO FEE
CONTRACTOR REGISTRATION FEE ALL CONTRACTORS	\$15.00
One- & two-Family Res. Buildings	\$75.00 per sq. ft - \$3.50 per thousand
Residential Additions	\$75.00 per sq. ft - \$3.50 per thousand
Residential Remodel	\$55.00 per sq. ft - \$3.50 per thousand
Residential Garages, Breezeways, Carports, Pole Buildings	\$45.00 per sq. ft - \$3.50 per thousand
Multiple Family Dwellings	\$80.00 per sq. ft – \$4.50/M per Bldg. up to & including \$200.00 - \$3.50/M thereafter. Separate Permit for each Building
Mobile/Modular Homes – In Park	\$210.00 *Includes Plumbing & Mechanical Inspections (Electrical is not included)
Basement under Existing Building	\$150.00
All Swimming Pools	\$25.00 above ground \$100.00 in ground
Deck	\$150.00 2 inspections footing/final
SHEDS OVER 200 SQUARE FEET	\$50.00
Demolition	150.00
Zoning Fee (ALL BUILDING PERMITS)	\$40.00
VARIANCE \$350.00. ZONING CHANGE \$400.00. SITE CONDOS, PC-1 & PR-1 \$550.00	CONDITIONAL USE \$400.00. HOME OCCUPATION \$300.00. SITE PLAN REVIEW \$450.00 ADMIN. SITE PLAN REVIEW \$175.00
ALL COMMERCIAL & INDUSTRIAL BUILDING WILL BE COMPUTED BY THE BS&A SOFTWARE PER BUILDING TYPE AND SQ. FT:	1/10 th of 1% for Plan Review \$50.00 for 1 st Thousand or Fraction thereof \$4.00/M thereafter up to \$200,000.00; \$3.00/M thereafter
SIGN: TEMPORARY \$35.00 FOR 15 DAY IN A 90 DAY PERIOD	COMMERCIAL SIGNS ESTIMATED COST THEN CALCULATED AS ABOVE MINUS PLAN REVIEW
REPLACE SHINGLE TEAR OFF AND REPLACE	\$50.00
REPLACEMENT WINDOWS	\$50.00
SOLAR: GROUND MOUNTED SOLAR PANELS	\$150.00 (2 INSPECTIONS)
SOLAR: ROOF MOUNTED (RESIDENTIAL ONLY)	\$50.00